

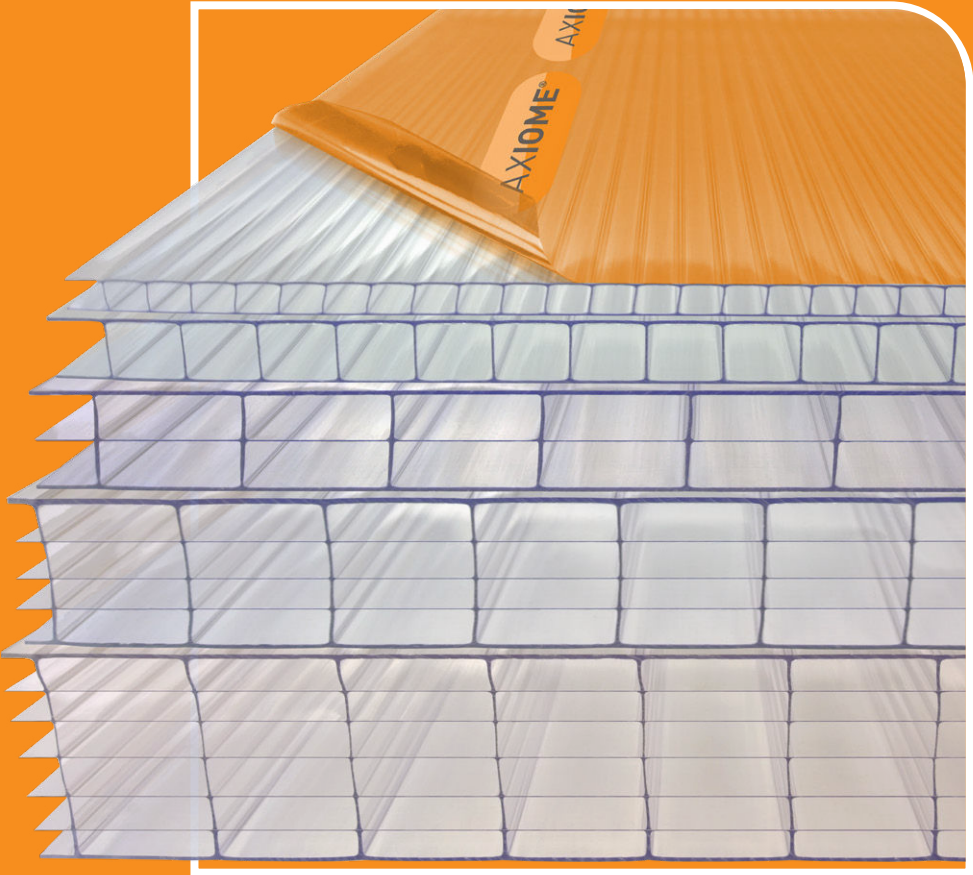

# Multiwall Polycarbonate Products Installation Guide



# AXIOME® : Installation Guide

**\*Internal structure illustrative only, and may vary from batch to batch**

4mm Twinwall



6mm Twinwall



10mm Twinwall



16mm Triplewall



25mm Multiwall



35mm Multiwall

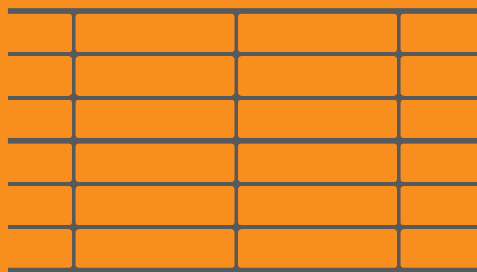

## 16mm Endstop bar

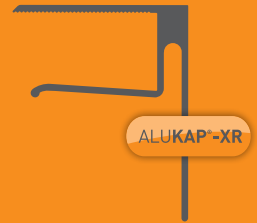

\*Recommended item

## Anti-dust tape

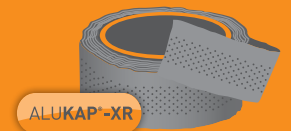

\*Optional item

## Tools required



Protective gloves and glasses



Tape measure, power saw and a fine bladed jigsaw



AXIOME® compatible sealant and sealant gun

## Installation

**1** Take all **Measurements** of the roof

If fitting with ALUKAP®-XR bars, please refer to the fitting guide.

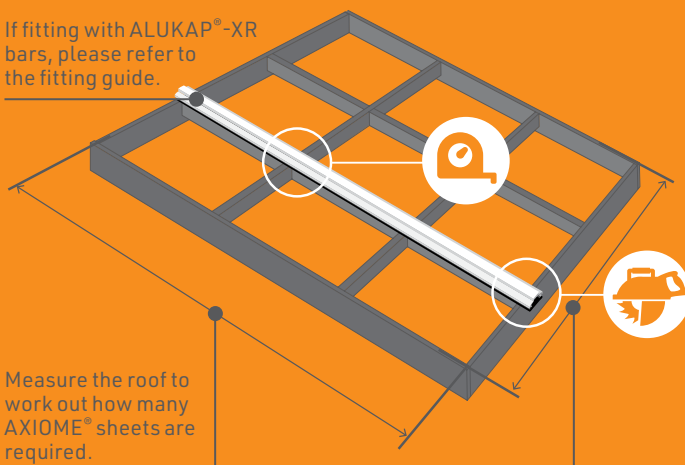

Measure the roof to work out how many AXIOME® sheets are required.

**2** Prepare the **AXIOME® Sheets** before installation

**IMPORTANT** - Store the AXIOME® sheets in a **clean, dry area** to prevent moisture getting into the flutes.

There is **protective film on both sides** of the AXIOME® sheet. The AXIOME® branded tape side is **UV protected**.

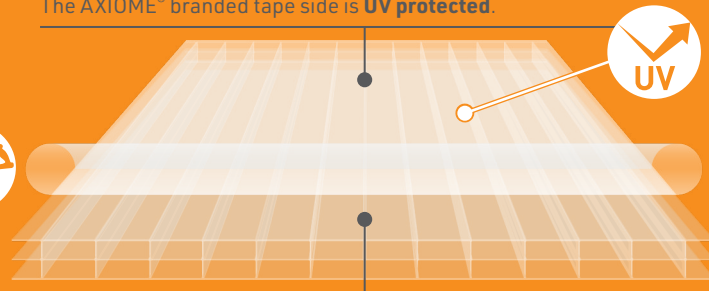

Ensure that you are working in a **clean dry area**, pull the **protective film back approximately 100mm from the open edge on both sides**, taking care not to scratch the surface.

[View Our How to Cut AXIOME® Polycarbonate Roofing Sheets Video](#)

### 3 Apply the **Anti-Dust Tape** to the AXIOME® sheets

**IMPORTANT** – All adhesives suffer reduced initial bonding strength in cold conditions – **avoid applying tape below 5°C.**

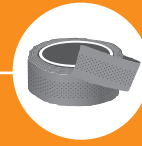
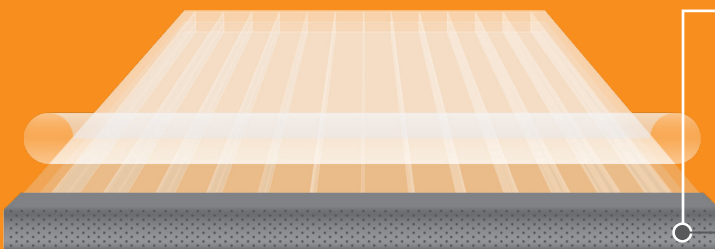

Stick the **AXIOME® Anti-dust Breather Tape** onto the top surface in a straight line from one side to the other, allowing enough to wrap around and bond to the underside. **If it is necessary to join the tape mid-panel, ensure that there is a minimum 25mm overlap.**

### 4 Part apply the **ALUKAP®-XR Endstop bar** to the AXIOME® sheets

We recommend using the ALUKAP®-XR Endstop bar as a sheet closure at the bottom sealed end. Cut the ALUKAP®-XR Endstop bar to the width of each AXIOME® sheet, and **push-fit on partway ONLY** so that the **open edge of the Endstop bar just covers the anti-dust breather tape.**

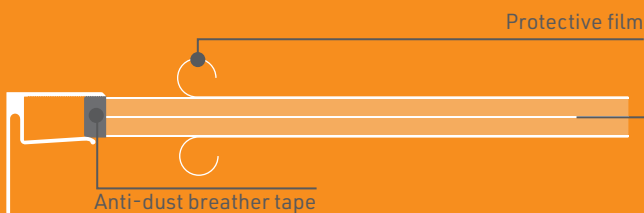

### 5 Apply the **AXIOME® compatible sealant**

Run a thin, consistent line of AXIOME® compatible sealant (LMN Silicone) along the edge of the **Endstop bar and Anti-dust Breather Tape**



### 6 **PUSH** the ALUKAP®-XR Endstop Bar in place

Push the **ALUKAP®-XR Endstop bar fully into place leaving an air gap**, so that the leading edge slides over the bead of sealant, creating a seal that eliminates capillary action.



The AXIOME® sheet is now ready for installation.

# 6

## Place in position and secure in place with glazing bars

**IMPORTANT** – Where the glazing bars ride over the **ALUKAP®-XR Endstop bar**, special attention must be given to applying sealant at this point, thereby ensuring no water ingress.

Pull the protective film back 100mm from all sides, place in position and secure in place with the glazing bars.

Apply a layer of sealant where the ALUKAP®-XR bar gasket overlaps the ALUKAP®-XR Endstop bar only.

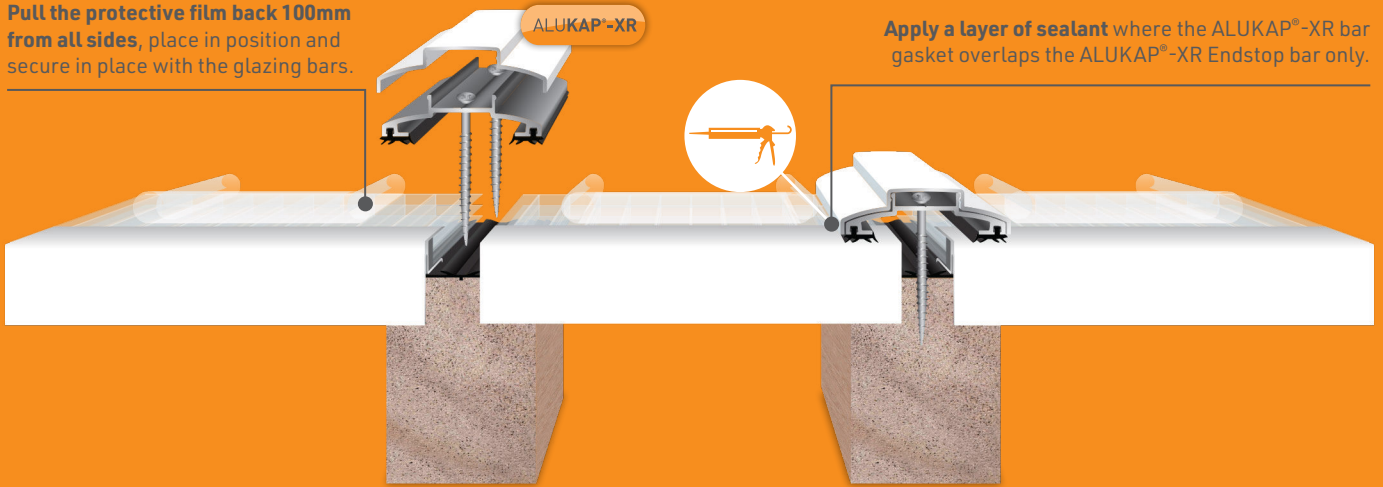

# 7

## REMOVE THE PROTECTIVE FILM from the AXIOME® sheets

**IMPORTANT** – Once the **AXIOME® sheet** has been installed, remove the protective film on both sides immediately, making sure that it's clean before removal, so that dirt or dust particles are not transferred to the surface of the AXIOME® sheet.

**ANY CLEANING REQUIRES** the use of plenty of clean, soapy water and a soft, abrasive-free cloth.



## WARNING : REGISTERED DESIGNS & PATENTS

The IP of the designs in this brochure are protected by internationally registered design rights. Many products are also protected with active or pending Patents. Clear Amber will not hesitate to take appropriate legal action if its rights in this respect are infringed.

### Disclaimer

Once AXIOME® multiwall polycarbonate sheet has left our warehouse, we cannot control transportation, storage, installation or handling, nor can we influence installation conditions, Clear Amber Group cannot be held responsible in any

way for condensation issues or other installation problems that may arise, or any associated remedial work. All advice is offered in good faith based on our experience. Installers should apply best practices before and during installation.

© Copyright – Clear Amber Group Ltd – August 2022. No part of this publication may be copied, reproduced, scanned, or stored in any electronic database, whether in whole or in part, in any form or by any means, without permission in writing from Clear Amber. Clear Amber will not hesitate to take appropriate legal action if its rights in this respect are infringed.

Inasmuch as Clear Amber have no control over the circumstances in which our material may be used, or site specific parameters, we cannot guarantee that any particular results will be achieved. Users should carry out their own tests to determine the suitability of the material for their application.